

ST. LUKE'S SCHOOL



**Phase III:
Advancing Our Mission**

Message from Head of School Mark Davis

The Latin root of the word “community” means “to build together.” St. Luke’s is a community that exists to challenge and support students and to “build together” the soul of the child. This is a shared opportunity at St. Luke’s, to look to the past (our alumni and past parents), the present (our current parents), and the future (incoming classes), to build the school together.

As we strive to meet the goals of the third phase of *The Campaign for St. Luke’s School*, I am drawn to a portion of our mission which states, “St. Luke’s recognizes that intellectual and personal growth occur both in and out of the classroom; therefore both academic and non-academic programs foster the pursuit of excellence, strength of character and a healthy self-image.”



We have accomplished so much in our pursuit of the facilities that are consistent with the School’s mission and my vision for the School. Excellence. Heart. Connectedness. Community. The construction of a new Athletic Center occurs outside our doors. These facilities will give our students the opportunities they deserve as well as provide community spaces in which we can gather, share, and learn together. Better and more varied outlets for teamwork, creativity, perseverance, compassion, and school spirit will confirm and deepen our longstanding emphasis on educating the whole of every child, on encouraging every child to try something new, and on providing every child with opportunities to succeed and grow. All of this has been accomplished in the last four years.

We look toward the Performing Arts Center as our next accomplishment, and when its doors open to welcoming our whole community, we will not know how we got along without it. I cannot wait to see how our thespians - from novice to experienced - flock to the new St. Luke’s stage.

The growth of St. Luke’s endowment is also a major component of this phase of the campaign. The key to financial success of any private educational institution is a commitment to increase its endowment fund. The growth of our endowment will provide St. Luke’s with the financial strength and flexibility to meet the school’s future needs.

The heart and soul of St. Luke’s has always been and will remain our faculty and staff. These dedicated professionals inspire, motivate, instruct and nurture your children. The Board of Trustees and I are committed to attracting and retaining the highest quality educators. A portion of the endowment will be made available for faculty needs and will provide us with the means to accomplish this goal.

I invite you to join me in this exciting endeavor as we continue to build an environment that supports the school motto: Enter to Learn and Go Forth to Serve.

With Warm Regards,

A handwritten signature in black ink, appearing to read "Mark Davis". The signature is fluid and cursive, with a large, stylized "S" at the end.

The Campaign for St. Luke's School

Phase III: Advancing our Mission

The Campaign for St. Luke's School began in 1999--the result of a master planning process led by the Board of Trustees. The generosity of St. Luke's parents, alumni and friends has given our students the Fine Arts Center, the impressive Academic Addition, and extensive interior renovations to the school.

In 2002, the Campaign entered Phase III. Its most ambitious phase, Phase III includes construction of an Athletic Center, a Performing Arts Center, and \$2 million growth in the Endowment. The Athletic Center has become a reality. We move in earnest toward our next goal of constructing the Performing Arts Center and supporting our faculty through Endowment growth.

Building the Performing Arts Center will complete the circle of facilities needed to have a well-rounded and comprehensive program of academics, athletics and the arts. The direct and immediate benefits to our students are numerous. Students using their creative and public talents through acting will be able to perform in a true theater space, under the guidance of a full drama and music curriculum, while technical drama students will learn stage management. Eighth-graders can complete their declamations--a learning process for public speaking--on the stage of the auditorium. Outside speakers can use the auditorium to enrich us as a community of learners. And, of course, the Performing Arts Center will be a place that we can all gather as a school, to celebrate victories, share information and build community spirit.

St. Luke's continues its commitment to strengthen the endowment. Our goal is to raise \$2 million during this phase of the campaign to bring the total endowment to \$5 million.

The realization of this \$14 million goal will have an immeasurable impact on the lives of our students, faculty, alumni, and the community. Each of us can look forward to a St. Luke's School that is stronger and more vibrant than ever before. An excellent school with a long and proud tradition of educating young people will become a great institution with the facilities and financial security to advance assertively into this century.

Phase III Goal	
Athletic Center & Site Work	\$9,000,000
Performing Arts Center	\$3,000,000
Endowment	\$2,000,000
Phase III Goal	\$14,000,000

The Performing Arts Center

St. Luke's first dedicated theater will foster imagination, creativity, community spirit and confidence -- all integral components of a well-rounded education. A technologically advanced theater will inspire our students to fully develop their capabilities in the performing arts and attract artistically-gifted prospective students to St. Luke's.

The Performing Arts Center will feature:

- the largest number of seats of any theater in the Fairchester League (500 fixed and retractable). Seating at Fairchester schools currently ranges from 300 to 450 total.
- 1,800 square feet of additional space for rehearsals when lower two-thirds of seats are retracted beneath balcony seats.
- a control room where students can learn how technical production is run from a remote position and how the back of the house communicates with those on stage.
- a vertical overhead flying system for the movement of scenery which will give students operating familiarity when they advance to the college level.
- a moveable dividing wall on the stage allowing two programmatic elements to occur simultaneously such as a choral/drama space or dance studio/technical staging area.
- technologically advanced lighting and sound equipment.

A new theater benefits the entire school community by:

- encouraging communication, school spirit and a small school atmosphere.
- enabling students to applaud and recognize the academic, athletic, cultural and civic achievements of their peers.
- allowing for frequent assemblies for the upper and middle schools.
- making possible a speaker series to enrich student life.
- facilitating the introduction of drama and dance into the curriculum and expanding the music program.
- enabling faculty and staff to conduct professional training and workshops on campus.
- providing an opportunity for a summer theater program.



Main Level

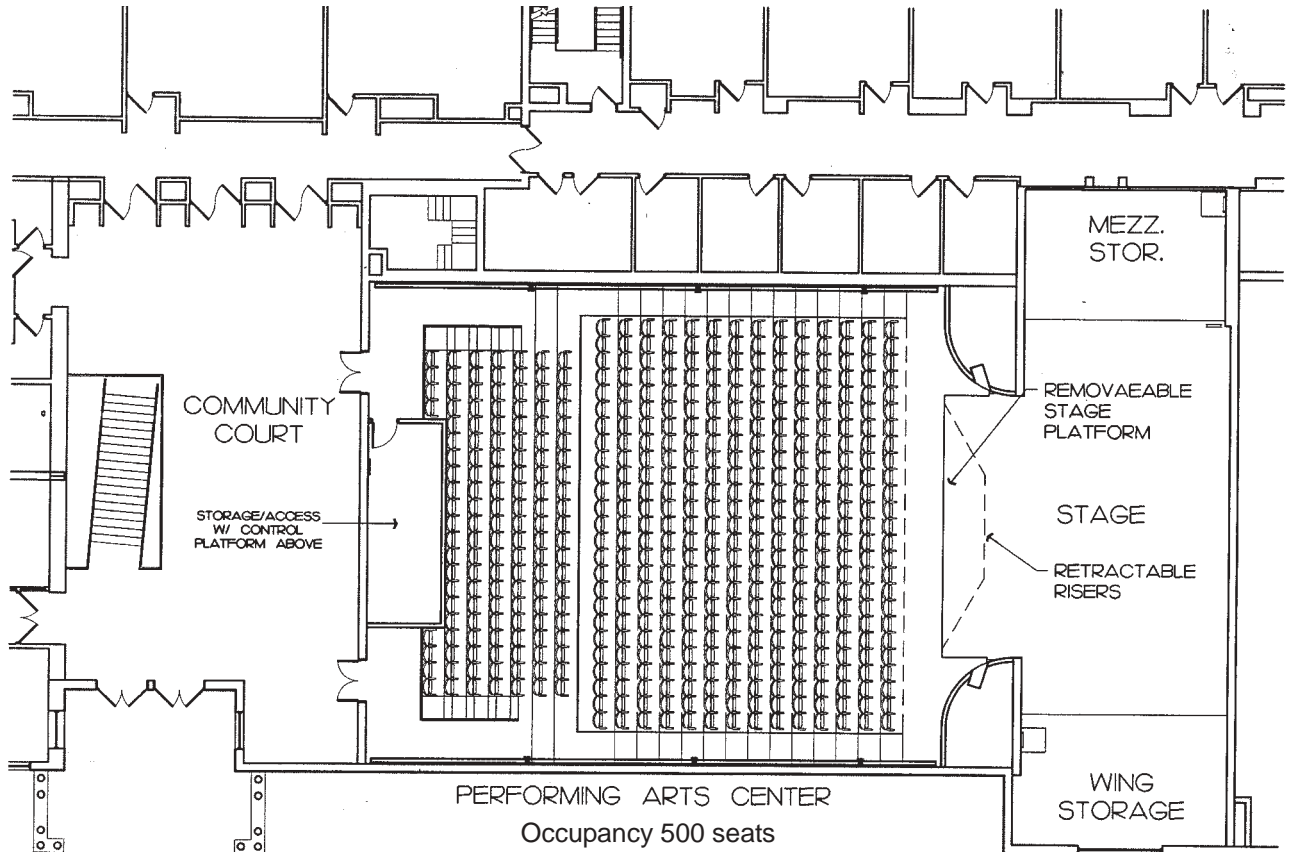

Lower Level

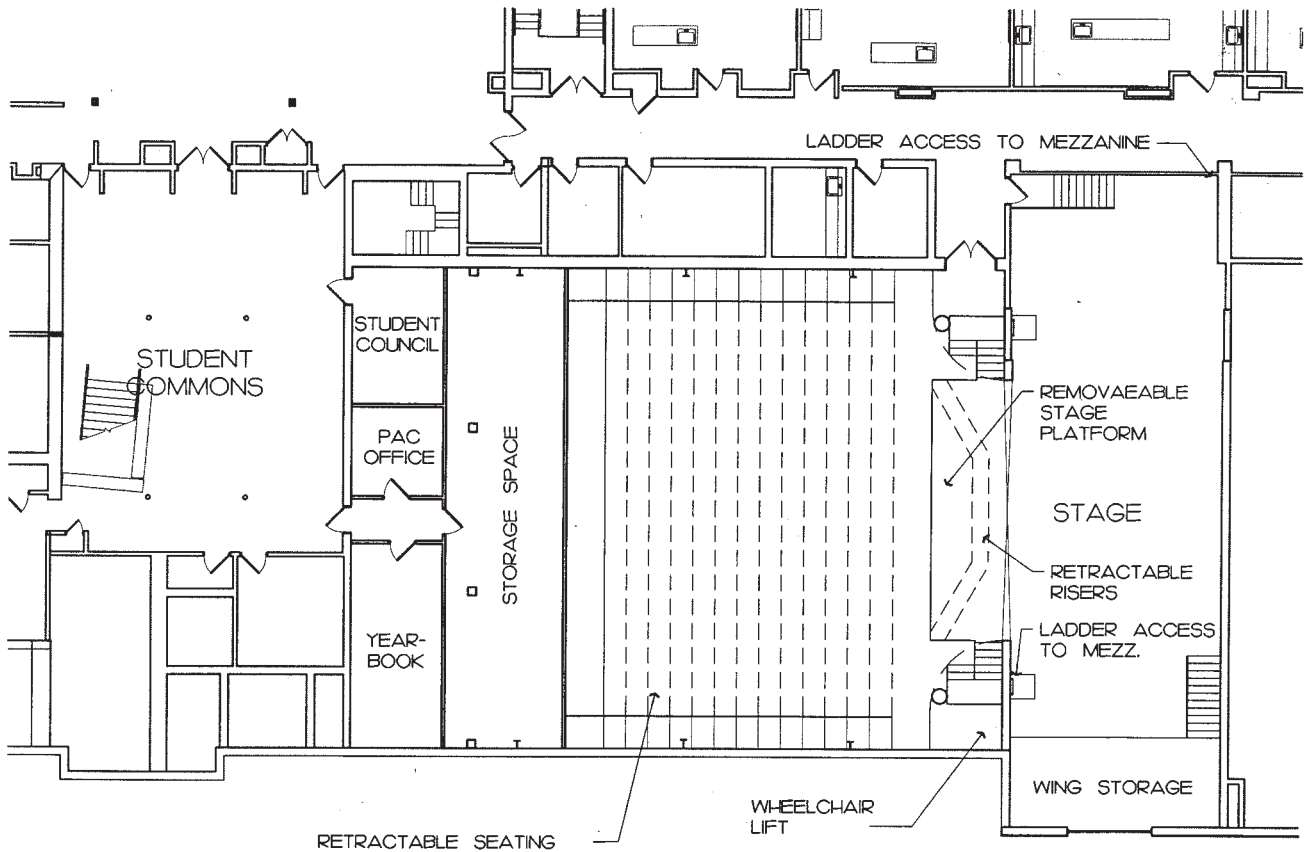

Investing in Our Future

St. Luke's Endowment Fund

We hear repeatedly from our alumni that their fondest memories of St. Luke's involve a trusted faculty or administrator who changed their lives for the better. Caring, committed, inspiring, challenging, encouraging, kind...these qualities describe St. Luke's because they describe our faculty.

The Board is dedicated to investing in our intellectual capital and is fully aware that imaginative, energetic teaching that stimulates academic and personal growth is the keystone of our mission. Growing the endowment will enable us to align our financial priorities with our intellectual commitment. Income from a healthy endowment will further enable us to hire and retain top educators, to offer competitive salaries and benefits packages, and to invest in continuous professional development, as well as to operate the School. It is a commonly accepted index among independent schools that the endowment for a school such as St. Luke's should produce income equal to 10% of the operating budget. Given the fact that our current operating budget is \$10 million, we know that we must aspire to building our endowment to \$20 million (based on a prudent spending policy of 5% of the fund's value). As a first step in that direction, the Board has set a preliminary goal to bring our endowment to \$5 million by the end of the Campaign.



You are Vital to our Success

Our students benefit daily from the work that has been completed by *The Campaign for St. Luke's School*. Thanks to the generosity and commitment of families in the St. Luke's community, the Fine Arts Center, the impressive Academic Addition and the renovated Main Building house a vibrant, functional and attractive environment conducive to teaching and learning. The Athletic Center will do the same once it opens next spring.

This Campaign is about our students -- the opportunities they have to inquire, experiment and learn, and the life-changing relationships they build with caring faculty. It is about helping our students reach their full potential to be lifetime learners and socially responsible citizens. The Campaign reflects what you value in educating your children and why you chose St. Luke's as your place at this time.

Please join us as we move to complete the third phase of *The Campaign for St. Luke's School*. In a small community like this, every gift makes a big impact. Every gift is needed. Together we can make the Performing Arts Center a reality for our students. The timing of when the Performing Arts Center can be constructed is in our hands.

Please make a gift today. Naming opportunities are available should you want to honor your family, your children, a faculty member or loved one. The Campaign also welcomes multi-year pledges if that is helpful to you in making the gift you want. A Campaign representative is happy to answer any questions you have. The Development Office is also here to help. We are in this together.

We can do it -- with you.

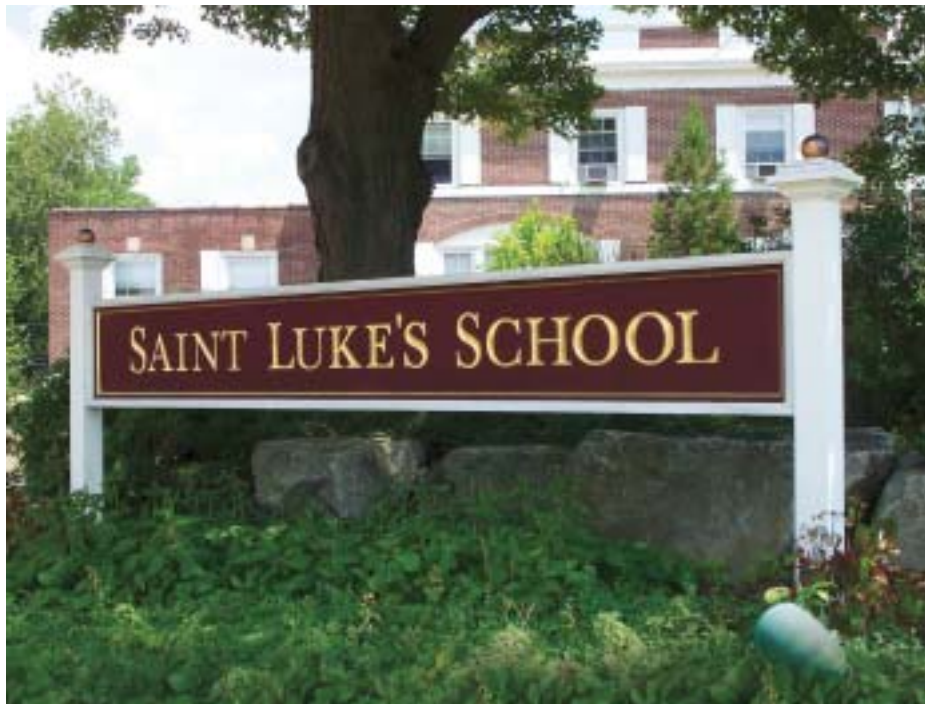

The Campaign for St. Luke's School

Steering Committee

Wendy Carey, *Chair of The Campaign for St. Luke's School*

Sally Schenk, *Co-Chair of the Development Committee*

Jim Parsons, *Chair of Major Gifts Committee*

Renée Bornstein, *Chair of Parents Committee*

Richard Whitcomb, *Alumni Representative*

Mark Davis, *Head of School*

Ninette Enrique, *Director of Development*

Parents Committee

Renée Bornstein, *Chair*

Kristen & Mark Begor
Martha B. Connolly
Buell G. Duncan
Woodson B. Duncan
Taylor Gibson-Ullman
William D. Hollingsworth

Jim & Maggie Hornung
Mark & Virginia Lastner
Amanda Layng
Jane & Ed Lyons
Lois Meyer
Christy Murray

Mickey Kelly-Murray
Betsy Petrucci
Sheila & Tim Pettee
Jay Phinney
Sally Schenk
Doug Taylor

Building Committee

Sal Campofranco, *Chair*

Brian Baer, *Architect*

Mark Davis, *Head of School*

Larry Foote, *Director of Facilities*

John Kelly, *Parent Representative*

Peter Santella, *Parent Representative*

Judy Sherwood, *Business Manager*

Board of Trustees

Bill Wicker, *Chair*

Sally Schenk, *Vice Chair*

Peter Seldin, *Treasurer*

Mickey Kelly-Murray, *Secretary*

Alex Baudouin
Sal Campofranco
Wendy Carey
Jim Fieber
Mike Gallagher
Gary Holloway
John Kelly

Cindi Kunkel
Virginia Lastner
Holly Mensching
Jeffrey Miller
Jo-Anne Morley
Jim Parsons
Dennis Perry

George Samenuk
Roy Scaffidi
Peter Shouvin
Helene Sullivan
Doug Taylor
Jeff Walker